

KAD32P-A

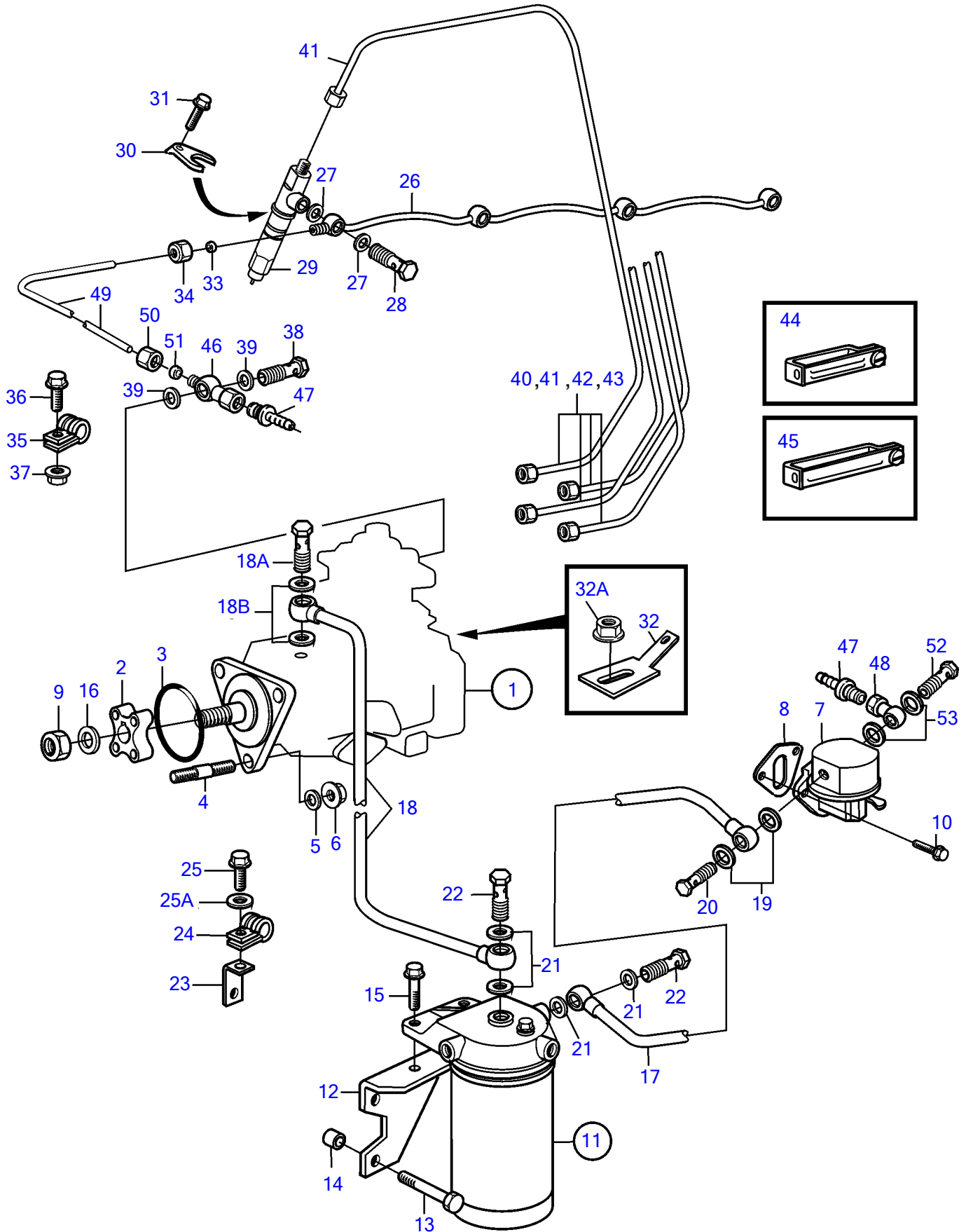

KAD32P-A

| REF | PART NO. | QTY | DESCRIPTION | SEE SEC. | NOTES |
|-----|----------|-----|-----------------------------|----------|----------------------------------|
| 1 | 3581451 | 1 | Injection pump | | Repl by 3581917 |
| | | | parts not sold separately | | |
| | 3581917 | 1 | Injection pump | | |
| | | | • parts not sold separately | | |
| 2 | 859601 | 1 | Hub | | For 3581451 |
| 3 | 968971 | 1 | O-ring | | |
| 4 | 980225 | 3 | Stud | | |
| 5 | 191172 | 3 | Washer | | |
| 6 | 945408 | 3 | Flange nut | | |
| 7 | 3582310 | 1 | Feed pump | | (860320) |
| 8 | 3501530 | 1 | Gasket | | |
| 9 | | 1 | Nut | | Included in fuel injection pump. |
| 10 | 946173 | 2 | Flange screw | | |
| 11 | 840531 | 1 | Fuel filter | | |
| | | | • | | |
| | | | • | 923 | |
| 12 | 3581698 | 1 | Bracket | | (838583) |
| 13 | 965193 | 2 | Flange screw | | |
| 14 | 843122 | 2 | Spacer sleeve | | |
| 15 | 946329 | 2 | Flange screw | | |
| 16 | | 1 | Washer | | Included in fuel injection pump. |
| 17 | 860447 | 1 | Fuel pipe | | |
| 18 | 838722 | 1 | Fuel pipe | | |
| 18A | 969299 | 1 | Hollow screw | | |
| 18B | 11994 | 2 | Gasket | | |
| 19 | 11994 | 2 | Gasket | | |
| 20 | 969299 | 1 | Hollow screw | | |
| 21 | 969011 | 4 | Gasket | | |
| 22 | 25167 | 2 | Hollow screw | | |
| 23 | 846780 | 1 | Bracket | | |
| 24 | 952624 | 1 | Clamp | | |
| 25 | 948746 | 1 | Flange screw | | (968855) |
| 25A | 955893 | 1 | Washer | | |
| 26 | 838666 | 1 | Leak-off line | | |
| 27 | 947620 | 8 | Gasket | | |
| 28 | 74033 | 4 | Hollow screw | | |
| 29 | 3581696 | 4 | Injector | | |
| | 3803372 | 4 | Injector, exch, exch | | |
| | | | • parts not sold separately | | |
| 30 | 861728 | 4 | Yoke | | |
| 31 | 946470 | 4 | Flange screw | | |
| 32 | 944485 | 1 | Cable terminal | | |
| 32A | 965483 | 1 | Flange nut | | |
| 33 | 956966 | 1 | Ferrule | | |
| 34 | 956980 | 1 | Fitting nut | | |
| 35 | 121563 | 1 | Clamp | | |
| 36 | 946544 | 1 | Flange screw | | |
| 37 | 945407 | 1 | Flange nut | | |
| 38 | 861514 | 1 | Hollow screw | | |
| 39 | 11994 | 2 | Gasket | | |
| 40 | 3581763 | 1 | Delivery pipe | | Cyl no 1 |
| 41 | 3581764 | 1 | Delivery pipe | | Cyl no 2 |
| 42 | 3581765 | 1 | Delivery pipe | | Cyl no 3 |
| 43 | 3581766 | 1 | Delivery pipe | | Cyl no 4 |
| 44 | 8194351 | 2 | Clamp | | 2-pipe |
| 45 | 8194353 | 2 | Clamp | | 4-pipe |
| 46 | 861080 | 1 | Banjo nipple | | |
| 47 | 3825000 | 2 | Hose nipple | | (834781) |
| 48 | 861079 | 1 | Banjo nipple | | |
| 49 | 3581450 | 1 | Return line | | |
| 50 | 956980 | 1 | Fitting nut | | |
| 51 | 956966 | 1 | Ferrule | | |
| 52 | 969299 | 1 | Hollow screw | | |

KAD32P-A

| REF | PART NO. | QTY | DESCRIPTION | SEE SEC. | NOTES |
|-----|----------|-----|-------------|----------|-------|
| 53 | 11994 | 2 | Gasket | | |